



© Crown copyright 2018
 Do not scale from drawings. Verify all dimensions on site prior to construction. This drawing is to be read in conjunction with all relevant documents and drawings. Report all discrepancies to MoJ immediately.
 No unauthorised use, disclosure, storage or copying.

This symbol identifies a Residual Risk that is recorded on the Design Risk Register and is relevant to this drawing.
 This drawing must be read in conjunction with the following project CDM documents:
 608623-0000-PEV-GHX0011-XX-HS-C-0002_Design Risk Assessment

This symbol identifies a Derogation that is recorded on the Derogation Schedule and is relevant to this drawing.
 This drawing must be read in conjunction with the following project Derogation documents:
 N/A

The above symbols can only be read when this drawing is in colour print

PRINT IN COLOUR

- NOTES:**
- DO NOT SCALE FROM THIS DRAWING
 - ALL DIMENSIONS ARE IN METRES UNLESS OTHERWISE STATED
 - ALL ROAD MARKINGS TO COMPLY WITH TRAFFIC SIGNS MANUAL (TSM) CHAPTER 5 AND THE TRAFFIC SIGNS AND GENERAL DIRECTIONS (TSRGD) 2016
 - PROPOSED ROAD MARKING TO TIE WITH THE EXISTING ROAD MARKINGS

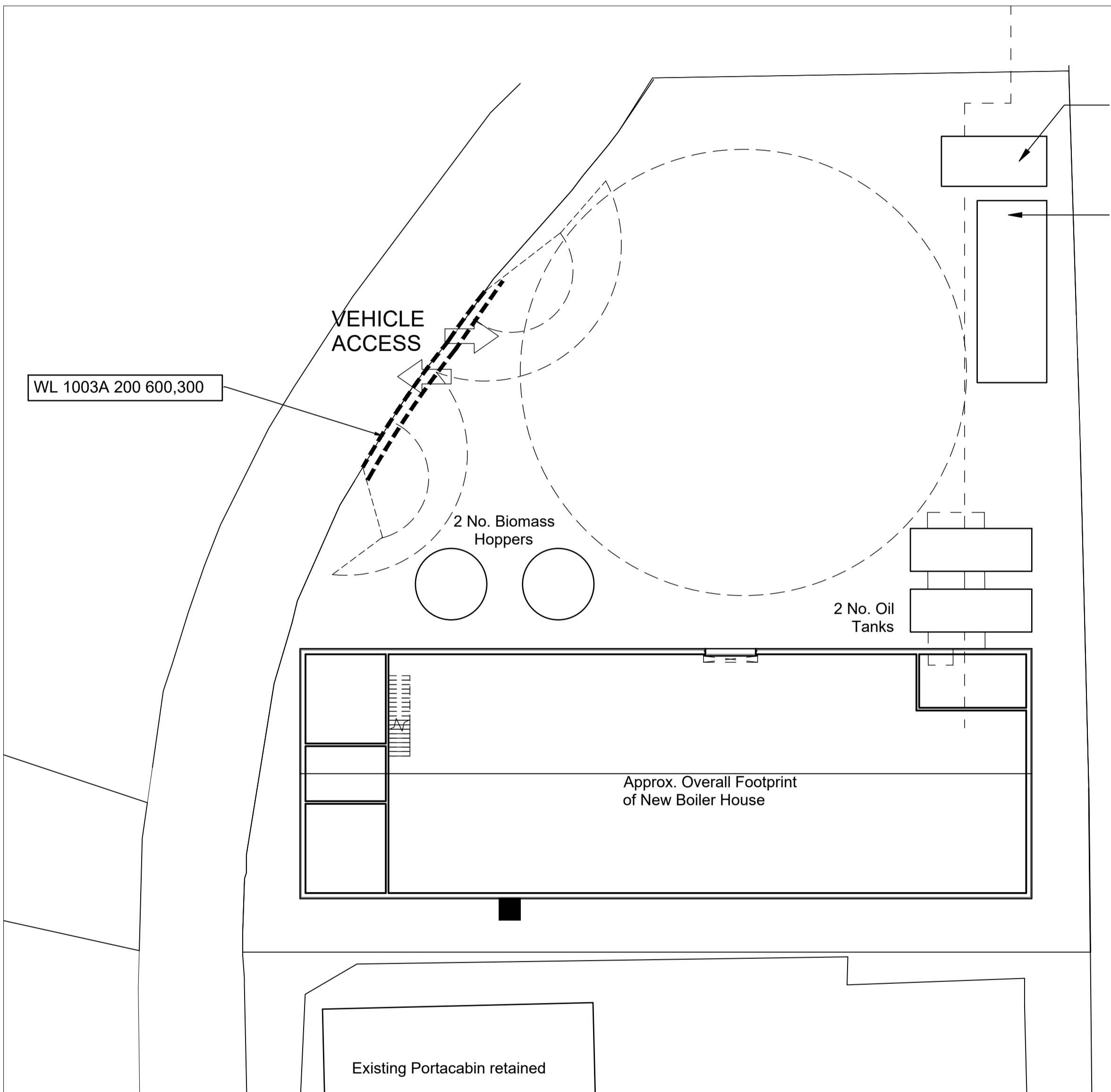
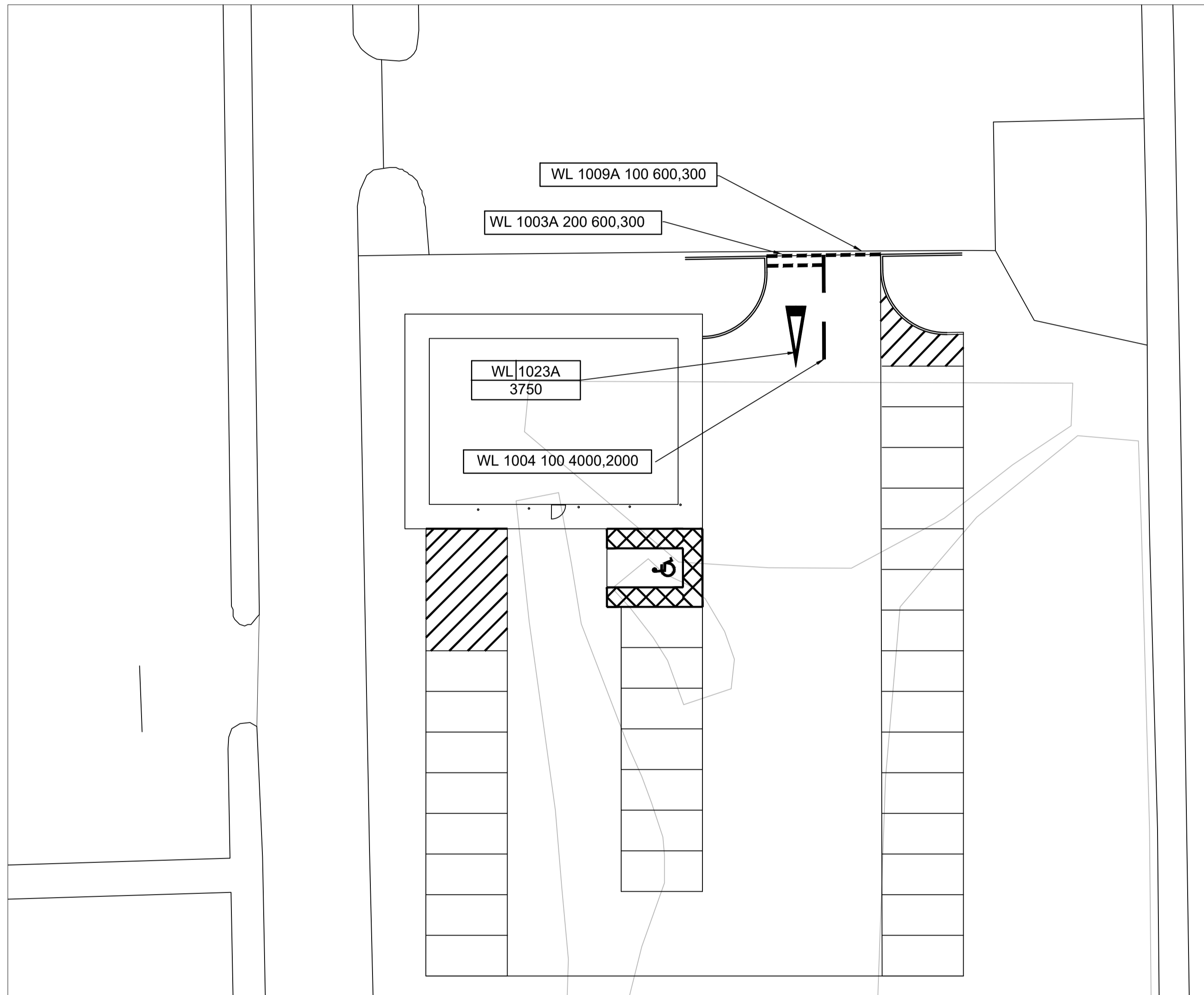

KEY:

	- PROPOSED CARRIAGEWAY
	- PROPOSED FOOTWAY
	- PROPOSED TACTILE PAVING AND DROPPED KERBS

Rev	Date	Description
P02	2021.07.08	GATE ADDED
P01	2021.07.05	FIRST ISSUE

Project Status
 RIBA Stage 2

 Ministry of Justice	Client
	Project
New Prisons Programme Ministry of Justice, 102 Petty France, London, SW1H 9AJ	

Project Description / Site
 New Prisons Programme
 Garth Wymott 2

Project Address
 Site Adjacent to HMP Garth & HMP Wymott

Building Type
 Boiler House - Site Infrastructure

Drawing Title
 Proposed Highways-General Arrangement Plan

	Originator Logo	Drawn By	KJD	Date	30.06.21
		Checked By	PC	Date	30.06.21
		Approved By	PC	Date	30.06.21

Drawing Number
 608623-0000-PEV-GHX0021-ZZ-DR-C-0700
 Delref
 D0100

Sheet No.	Scale	Orig. Sheet Size	Rev.
01 of 01	1:200	@ A1	P02

Data Security Classification
 OFFICIAL
 Suitability
 S3